



*makes your job easier*

# MASONRY FIXINGS

---

## PRODUCT CATALOGUE

# Hex Head Screw Bolt

Mechanical Galvanised

Purchase per Pack

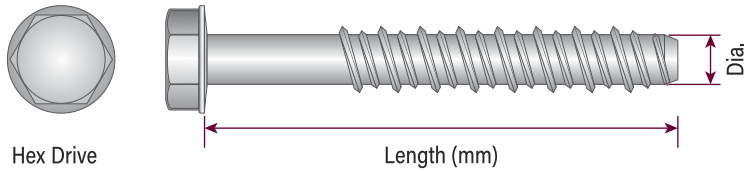

Mechanical Galvanised - Outdoor Use			
Dia.	Length (mm)	Product Code	Pcs / Pack
M5	50	SBGXM550-100	100
M6	30	SBGXM630-100	100
	50	SBGXM650-100	
	75	SBGXM675-100	
	100	SBGXM6100-100	
	120	SBGXM6120-100	
M8	50	SBGXM850-50	50
	60	SBGXM860-50	
	75	SBGXM875-50	
	80	SBGXM880-50	
	100	SBGXM8100-50	
	130	SBGXM8130-50	
M10	140	SBGXM8140-50	50
	60	SBGXM1060-50	
	75	SBGXM1075-50	
	100	SBGXM10100-50	
M12	120	SBGXM10120-50	25
	75	SBGXM1275-25	
	100	SBGXM12100-25	
M16	120	SBGXM12120-25	25
	150	SBGXM12150-25	
	100	SBGXM16100-25	
	150	SBGXM16150-25	

## Bottom Plate Fixing

Screw Bolt Hex Head

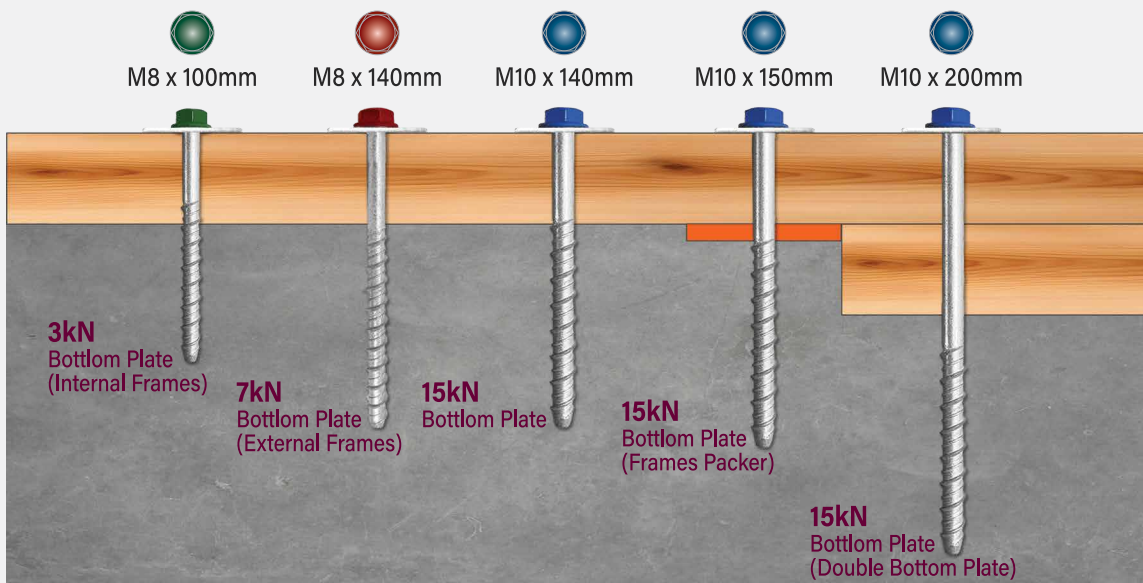

# 3kN Bottom Plate Fixing (Internal Frames)

Mechanical Galvanised

Purchase per Pack

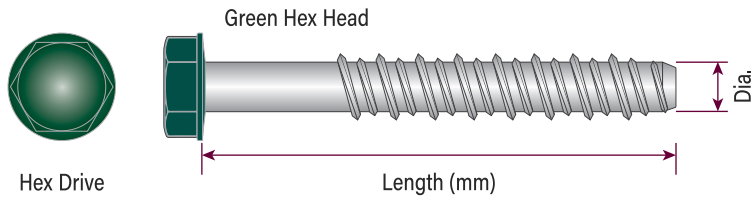

Mechanical Galvanised - Outdoor Use			
Dia.	Length (mm)	Product Code	Pcs / Pack
M8 / 3kN	100	SBGXM8100-50	50

# 7kN Bottom Plate Fixing (External Frames)

Mechanical Galvanised

Purchase per Pack

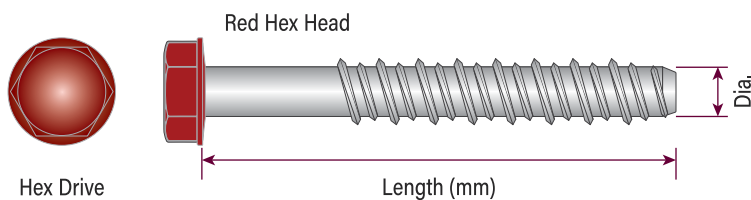

Mechanical Galvanised - Outdoor Use			
Dia.	Length (mm)	Product Code	Pcs / Pack
M8 / 7kN	140	SBGXM8140-50	50

# 15kN Bottom Plate Fixing

Mechanical Galvanised

Purchase per Pack

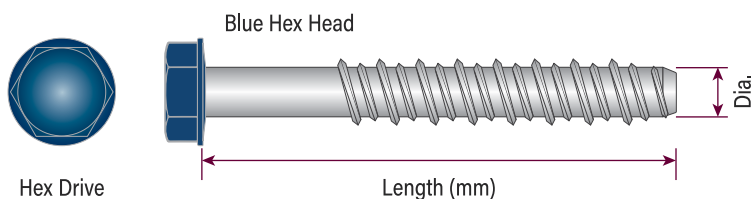

Mechanical Galvanised - Outdoor Use				
Dia.	Length (mm)	Product Code	Application	Pcs / Pack
M10 / 15kN	140	SBGXM10140-50	15kN bottom plate fixing	50
	150	SBGXM10150-25	15kN bottom plate fixing (frames packer)	25
	200	SBGXM10200-25	15kN bottom plate fixing (double bottom plate)	25

# 15kN Bottom Plate Fixing

Mechanical Galvanised

Washer Tub

Purchase per Tub

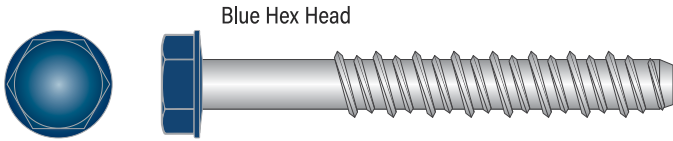

Blue Hex Head



Mechanical Galvanised - Outdoor Use				
Dia.	Length (mm)	Product Code	Application	Pcs / Tub
M10 / 15kN	140	SBGXM10140TUB-50	15kN bottom plate fixing	50
	150	SBGXM10150TUB-50	15kN bottom plate fixing (frames packer)	50

Includes



Washer  
50pcs



Socket driver bit  
1pc



Drill bit  
1pc



## Bottom Plate Fixing

Installation Guide

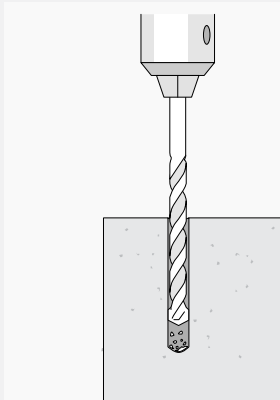

### Step 1

Using the correct masonry drill bit, drill a hole to the required embedment +10mm. Ensure that the minimum edge distance of 55mm is adhered to.

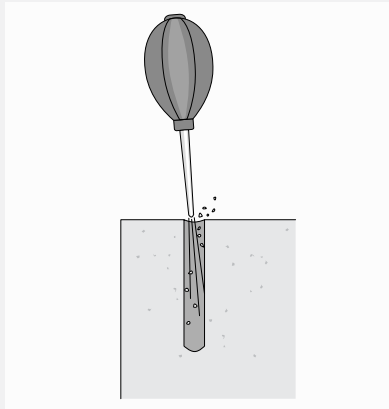

### Step 2

Clean dust and debris from hole.

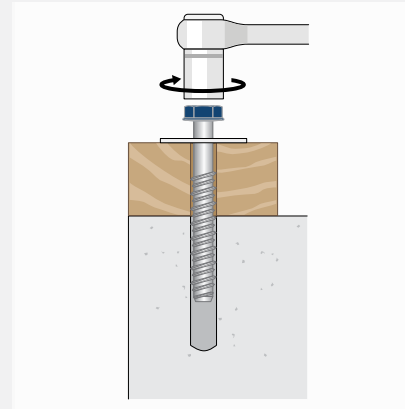

### Step 3

Screw in anchor using torque wrench or impact wrench until flange head is firmly secured against washer. **DO NOT OVER-TIGHTEN.**

# 15kN Bottom Plate Fixing

Mechanical Galvanised

Washer Tub

Purchase per Tub

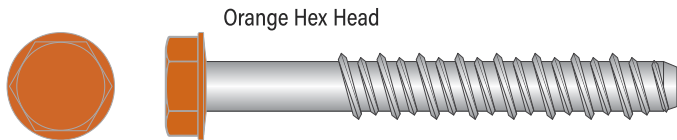

Mechanical Galvanised - Outdoor Use				
Dia.	Length (mm)	Product Code	Application	Pcs / Tub
M10 / 15kN	155	SBGXM10155TUB-50	15kN bottom plate fixing (insulated slab)	50

Includes



Washer  
50pcs



Socket driver bit  
1pc



Drill bit  
1pc



## Bottom Plate Fixing

Installation Guide

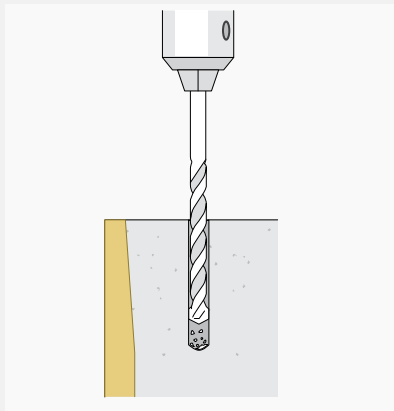

### Step 1

Using a 10mm masonry drill bit, drill a hole to the required embedment + 10mm. Ensure that the minimum edge distance (from outside of insulation) of 58mm is adhered too.

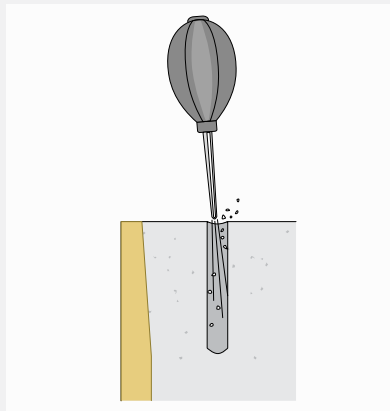

### Step 2

Clean dust and debris from hole.

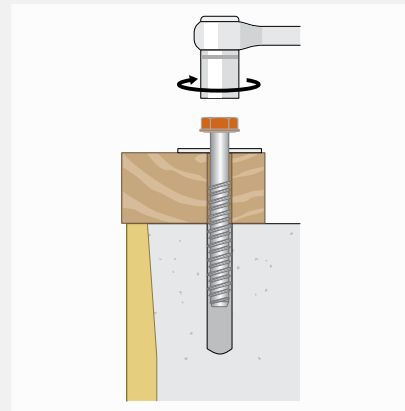

### Step 3

Screw in anchor using torque wrench or impact wrench until flange head is firmly secured against washer. **DO NOT OVER-TIGHTEN.**



ECKO M10 x 155mm Screw Bolt (orange head) 90mm bottom plate anchor solution is BRANZ tested (ST18050-01-02). For use with Firth's RibRaft HotEdge® insulation solution for concrete foundations. \*Please refer to [www.firth.co.nz](http://www.firth.co.nz) for installation guide.

# Countersunk Head Screw Bolt

Mechanical Galvanised

Purchase per Pack

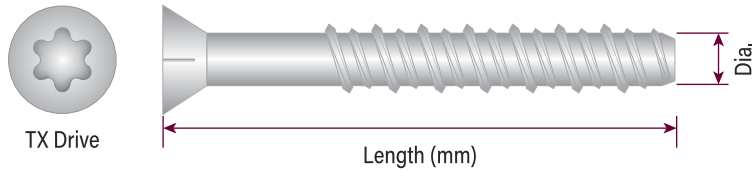

Mechanical Galvanised - Outdoor Use				
Dia.	Length (mm)	Product Code	Drive	Pcs / Pack
M6	50	SBGCM650-100	T30	100
	75	SBGCM675-100	T30	100
	100	SBGCM6100-100	T30	100
M8	60	SBGCM860-50	T40	50
	75	SBGCM875-50	T40	50
	100	SBGCM8100-50	T40	50
	130	SBGCM8130-50	T40	50
M10	75	SBGCM1075-50	T50	50
	100	SBGCM10100-50	T50	50
M12	100	SBGCM12100-25	T50	25
	150	SBGCM12150-25	T50	25

# Countersunk Head Masonry Screws

Mechanical Galvanised

Purchase per Pack

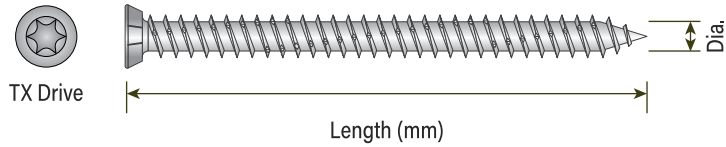

## Mechanical Galvanised - Outdoor Use

Dia. (mm)	Length (mm)	Drilled Hole (mm)	Product Code	Drive	Pcs / Pack
7.5	62	6	CONFIX62-100	T30	100
7.5	82	6	CONFIX82-100	T30	100
7.5	102	6	CONFIX102-100	T30	100

Includes

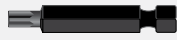

Driver bit  
1pc



Drill bit  
1pc



# Through Bolt

Hot Dip Galvanised

Purchase per Pack

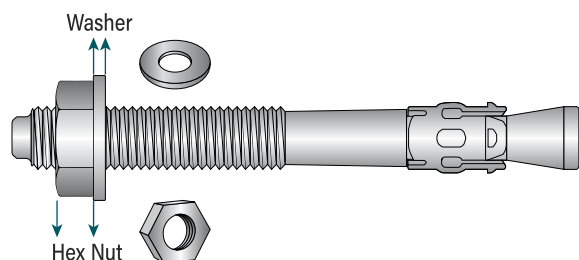

Hot Dip Galvanised - Outdoor Use			
Dia.	Length (mm)	Product Code	Pcs / Pack
M8	80	TBGM880-100	100
	100	TBGM8100-100	100
	120	TBGM8120-100	100
M10	65	TBGM1065-50	50
	90	TBGM1090-50	50
	120	TBGM10120-50	50
M12	80	TBGM1280-25	25
	100	TBGM12100-25	25
	120	TBGM12120-25	25
	135	TBGM12135-25	25
M16	180	TBGM12180-25	25
	105	TBGM16105-25	25
	125	TBGM16125-25	25
	140	TBGM16140-25	25
	180	TBGM16180-25	25

# Through Bolt

316 Stainless Steel

Purchase per Pack

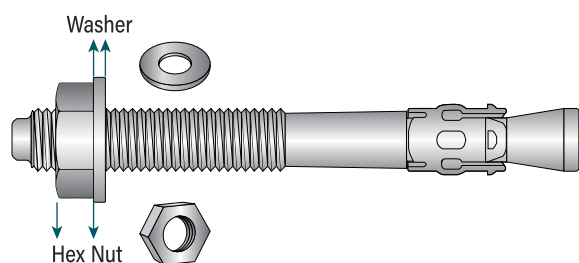

316 Stainless Steel - Outdoor & Sea Spray Zone Use			
Dia.	Length (mm)	Product Code	Pcs / Pack
M8	80	TBSS316M880-100	100
M10	90	TBSS316M1090-50	50
	120	TBSS316M10120-50	50
M12	80	TBSS316M1280-25	25
	100	TBSS316M12100-25	25
	120	TBSS316M12120-25	25
	135	TBSS316M12135-25	25
M16	180	TBSS316M12180-25	25
	105	TBSS316M16105-25	25

# Through Bolt

Hot Dip Galvanised

Washer Pack / Washer Tub

Purchase per Pack / Tub

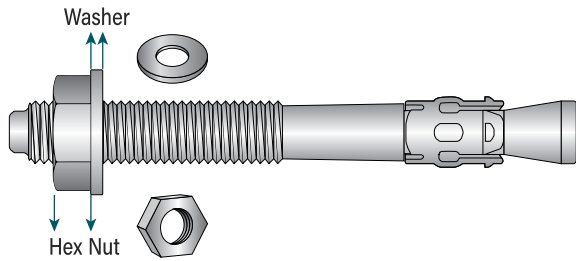

Hot Dip Galvanised - Outdoor Use

Dia.	Length (mm)	Product Code	Square Washer	Drill Bit	Quantity	Packaging
M12 / 7kN	135	TBGM12135SW-25	25	1	25	Box (Cardboard)
M12 / 7kN	135	TBGM12135TUB-50	50	1	50	Tub (Plastic bucket)

## Bottom Plate Fixing

Installation Guide

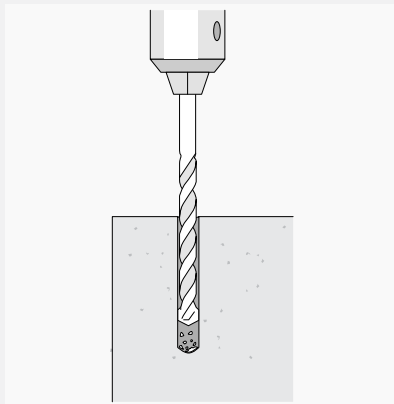
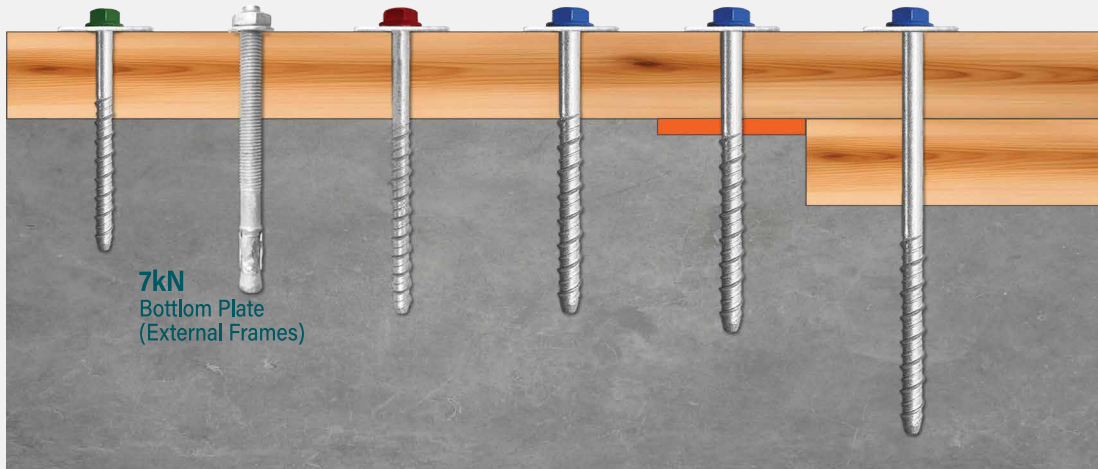

### Step 1

Using the correct masonry drill bit, drill a hole to the required embedment +10mm. Ensure that the minimum edge distance of 55mm is adhered to.

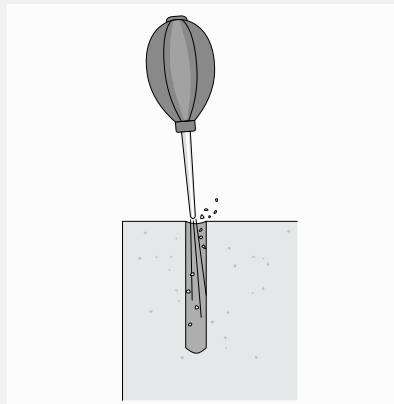

### Step 2

Clean dust and debris from hole.

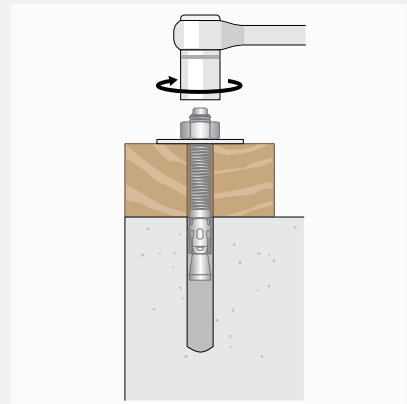

### Step 3

Screw in anchor using torque wrench or impact wrench until flange head is firmly secured against washer. **DO NOT OVER-TIGHTEN.**